

219

GRAND STREET CHINATOWN, NYC

Between Elizabeth & Mott Streets

RETAIL FOR LEASE

APPROXIMATE SIZE

850 SF

ASKING RENT

\$9,500/Month

POSSESSION

Immediate

TERM

5-10 Years

FRONTAGE

15 FT

COMMENTS

- Clean white-box space
- All MEP's in working order
- 24/7 foot traffic
- Located one-block from Nolita and Little Italy
- All dry uses considered

NEIGHBORS

Fox & Jane • Moxy Hotel • Prince Tea House • La Bella Beauty • Jiang Nan • Wah Fung • I'Milky • Pep's • Caffé Palermo • Casa D' Angelo • Ferrara 130

TRANSPORTATION

B D N Q 4 5 6 J Z



PROPERTY INFORMATION

JAMES FAMULARO
President

JOHN ROESCH
Director
212.468.5971
jroesch@meridiancapital.com

MARIKO TANAKA
Associate
212.468.5955
mtanaka@meridiancapital.com



MERIDIAN
RETAIL LEASING

All information supplied is from sources deemed reliable and is furnished subject to errors, omissions, modifications, removal of the listing from sale or lease, and to any listing conditions, including the rates and manner of payment of commissions for particular offerings imposed by Meridian Capital Group. This information may include estimates and projections prepared by Meridian Capital Group with respect to future events, and these future events may or may not actually occur. Such estimates and projections reflect various assumptions concerning anticipated results. While Meridian Capital Group believes these assumptions are reasonable, there can be no assurance that any of these estimates and projections will be correct. Therefore, actual results may vary materially from these estimates and projections. Any square footage dimensions set forth are approximate.

219 GRAND STREET

CHINATOWN, NYC | Between Elizabeth and Mott Streets

RETAIL FOR LEASE



INTERIOR

JAMES FAMULARO
President

JOHN ROESCH
Director
212.468.5971
jroesch@meridiancapital.com

MARIKO TANAKA
Associate
212.468.5955
mtanaka@meridiancapital.com



MERIDIAN
RETAIL LEASING

All information supplied is from sources deemed reliable and is furnished subject to errors, omissions, modifications, removal of the listing from sale or lease, and to any listing conditions, including the rates and manner of payment of commissions for particular offerings imposed by Meridian Capital Group. This information may include estimates and projections prepared by Meridian Capital Group with respect to future events, and these future events may or may not actually occur. Such estimates and projections reflect various assumptions concerning anticipated results. While Meridian Capital Group believes these assumptions are reasonable, there can be no assurance that any of these estimates and projections will be correct. Therefore, actual results may vary materially from these estimates and projections. Any square footage dimensions set forth are approximate.

219 GRAND STREET

CHINATOWN, NYC | Between Elizabeth and Mott Streets

RETAIL FOR LEASE

FLOOR PLAN

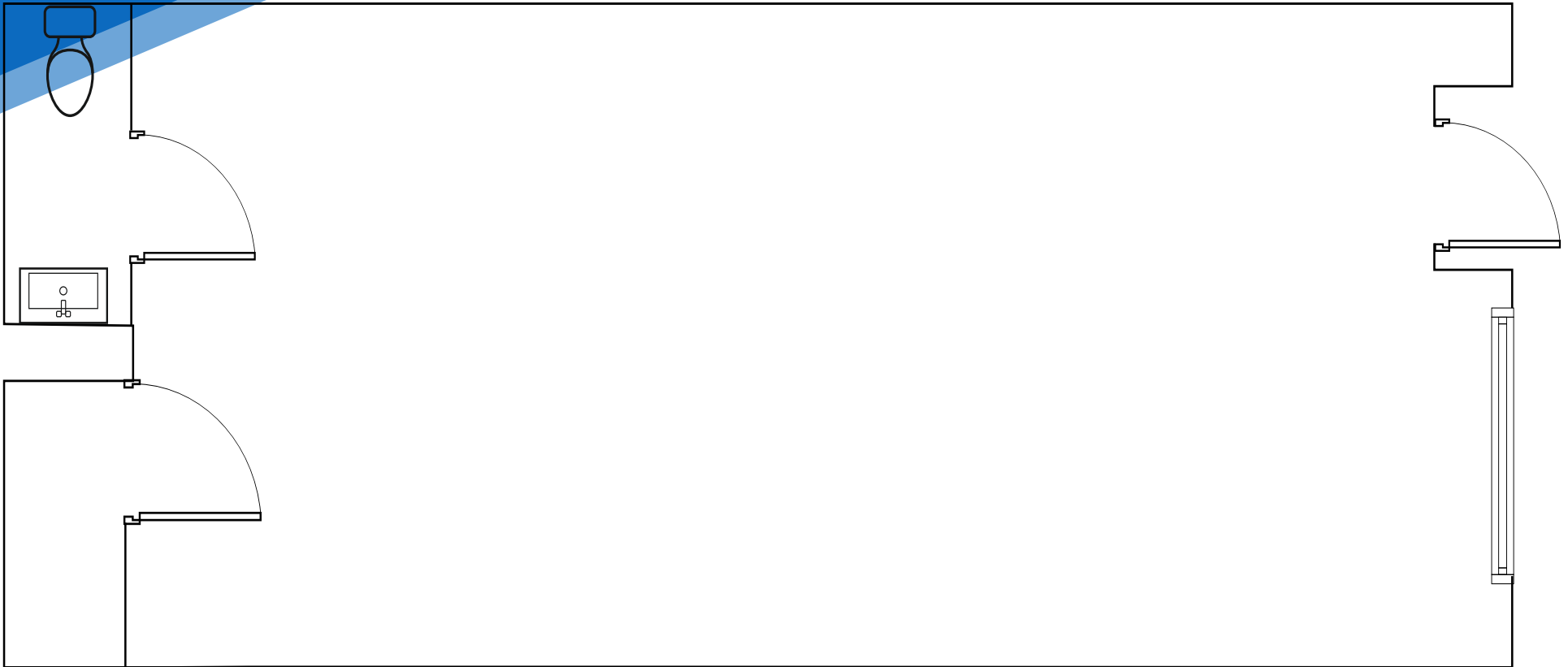

JAMES FAMULARO
President

JOHN ROESCH
Director
212.468.5971
jroesch@meridiancapital.com

MARIKO TANAKA
Associate
212.468.5955
mtanaka@meridiancapital.com



MERIDIAN
RETAIL LEASING

All information supplied is from sources deemed reliable and is furnished subject to errors, omissions, modifications, removal of the listing from sale or lease, and to any listing conditions, including the rates and manner of payment of commissions for particular offerings imposed by Meridian Capital Group. This information may include estimates and projections prepared by Meridian Capital Group with respect to future events, and these future events may or may not actually occur. Such estimates and projections reflect various assumptions concerning anticipated results. While Meridian Capital Group believes these assumptions are reasonable, there can be no assurance that any of these estimates and projections will be correct. Therefore, actual results may vary materially from these estimates and projections. Any square footage dimensions set forth are approximate.

219 GRAND STREET

CHINATOWN, NYC | Between Elizabeth and Mott Streets

RETAIL FOR LEASE



NEIGHBORS

JAMES FAMULARO
President

JOHN ROESCH
Director
212.468.5971
jroesch@meridiancapital.com

MARIKO TANAKA
Associate
212.468.5955
mtanaka@meridiancapital.com



MERIDIAN
RETAIL LEASING

All information supplied is from sources deemed reliable and is furnished subject to errors, omissions, modifications, removal of the listing from sale or lease, and to any listing conditions, including the rates and manner of payment of commissions for particular offerings imposed by Meridian Capital Group. This information may include estimates and projections prepared by Meridian Capital Group with respect to future events, and these future events may or may not actually occur. Such estimates and projections reflect various assumptions concerning anticipated results. While Meridian Capital Group believes these assumptions are reasonable, there can be no assurance that any of these estimates and projections will be correct. Therefore, actual results may vary materially from these estimates and projections. Any square footage dimensions set forth are approximate.