

# 28

## WEST 27<sup>TH</sup> STREET NOMAD, NYC

Between Broadway & Sixth Avenue

RETAIL/RESTAURANT FOR LEASE

### APPROXIMATE SIZE

Ground Floor: 6,000 SF  
Basement: 5,500 SF  
Total: 11,500 SF

### ASKING RENT

\$110 PSF

### POSSESSION

Arranged

### TERM

Negotiable

### FRONTAGE

60 FT

### COMMENTS

- Prime NoMad location with strong retail and restaurant co-tenancy
- Large signage opportunity
- Space can be vented
- All uses considered

### NEIGHBORS

Oscar Wilde • Patent Pending • Equinox • Pura Vida • Naya • Flatiron Room • 230 Fifth • Somewhere Nowhere • Anita Gelato • Plnt Burger • Bondi Sushi • Ilii • Madison Square Park

### TRANSPORTATION



### JAMES FAMULARO

President  
646.658.7373  
jfamularo@meridiancapital.com

### JORDAN LANGER

Associate  
212.468.5977  
jlander@meridiancapital.com

### JESSICA BLOCKER

Associate  
212.468.5928  
jblocker@meridiancapital.com



**MERIDIAN**  
RETAIL LEASING

All information supplied is from sources deemed reliable and is furnished subject to errors, omissions, modifications, removal of the listing from sale or lease, and to any listing conditions, including the rates and manner of payment of commissions for particular offerings imposed by Meridian Capital Group. This information may include estimates and projections prepared by Meridian Capital Group with respect to future events, and these future events may or may not actually occur. Such estimates and projections reflect various assumptions concerning anticipated results. While Meridian Capital Group believes these assumptions are reasonable, there can be no assurance that any of these estimates and projections will be correct. Therefore, actual results may vary materially from these estimates and projections. Any square footage dimensions set forth are approximate.

# 28 WEST 27<sup>TH</sup> STREET

NOMAD, NYC | Between Broadway and Sixth Avenue

## RETAIL/RESTAURANT FOR LEASE



INTERIOR

### JAMES FAMULARO

President  
646.658.7373  
jfamularo@meridiancapital.com

### JORDAN LANGER

Associate  
212.468.5977  
jlander@meridiancapital.com

### JESSICA BLOCKER

Associate  
212.468.5928  
jblocker@meridiancapital.com



**MERIDIAN**  
RETAIL LEASING

All information supplied is from sources deemed reliable and is furnished subject to errors, omissions, modifications, removal of the listing from sale or lease, and to any listing conditions, including the rates and manner of payment of commissions for particular offerings imposed by Meridian Capital Group. This information may include estimates and projections prepared by Meridian Capital Group with respect to future events, and these future events may or may not actually occur. Such estimates and projections reflect various assumptions concerning anticipated results. While Meridian Capital Group believes these assumptions are reasonable, there can be no assurance that any of these estimates and projections will be correct. Therefore, actual results may vary materially from these estimates and projections. Any square footage dimensions set forth are approximate.

# 28 WEST 27<sup>TH</sup> STREET

NOMAD, NYC | Between Broadway and Sixth Avenue

RETAIL/RESTAURANT FOR LEASE

FLOOR PLAN | GROUND FLOOR

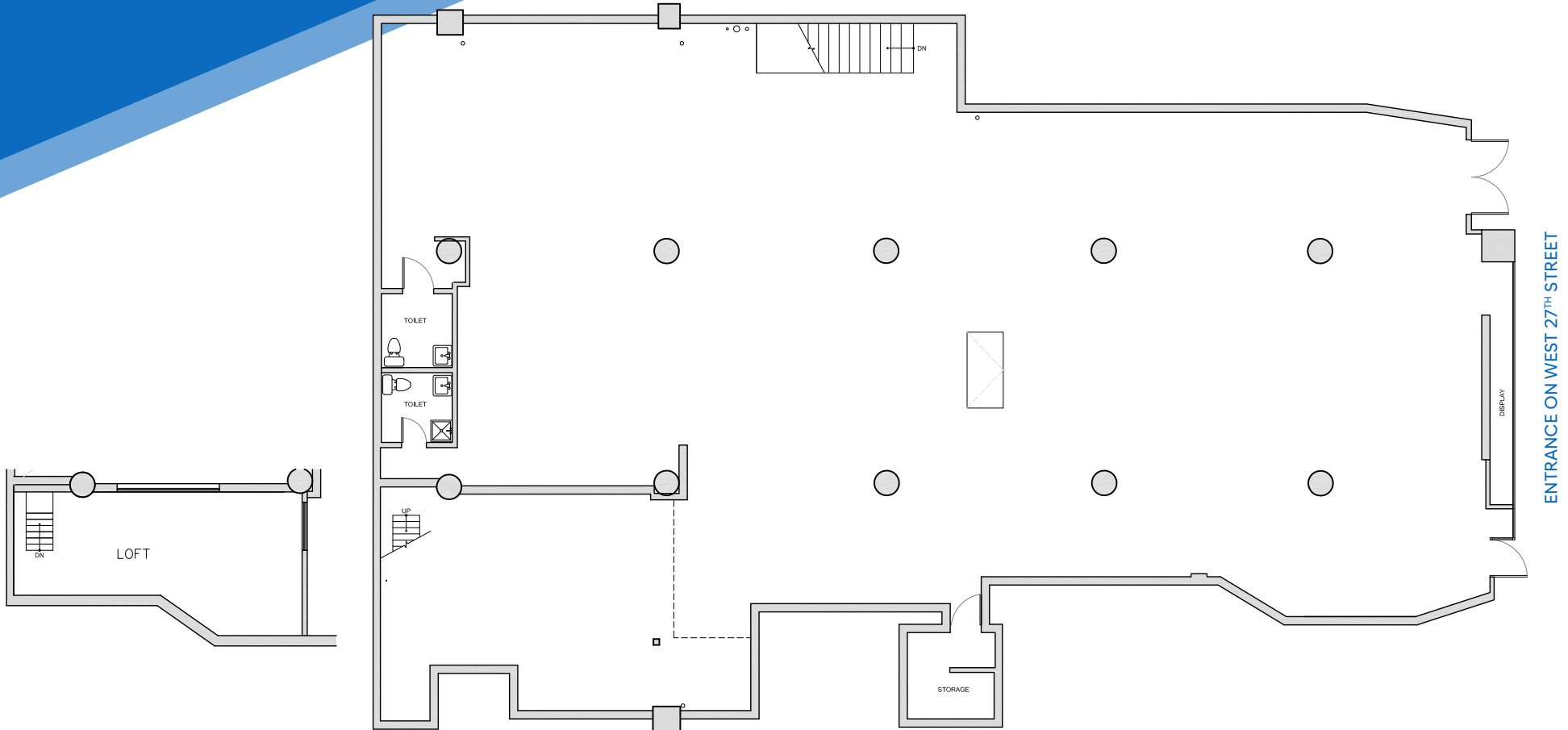

### JAMES FAMULARO

President  
646.658.7373  
jfamularo@meridiancapital.com

### JORDAN LANGER

Associate  
212.468.5977  
jlanger@meridiancapital.com

### JESSICA BLOCKER

Associate  
212.468.5928  
jblocker@meridiancapital.com



**MERIDIAN**  
RETAIL LEASING

All information supplied is from sources deemed reliable and is furnished subject to errors, omissions, modifications, removal of the listing from sale or lease, and to any listing conditions, including the rates and manner of payment of commissions for particular offerings imposed by Meridian Capital Group. This information may include estimates and projections prepared by Meridian Capital Group with respect to future events, and these future events may or may not actually occur. Such estimates and projections reflect various assumptions concerning anticipated results. While Meridian Capital Group believes these assumptions are reasonable, there can be no assurance that any of these estimates and projections will be correct. Therefore, actual results may vary materially from these estimates and projections. Any square footage dimensions set forth are approximate.

28 WEST 27<sup>TH</sup> STREET

NOMAD, NYC | Between Broadway and Sixth Avenue

RETAIL/RESTAURANT FOR LEASE

FLOOR PLAN | LOWER LEVEL

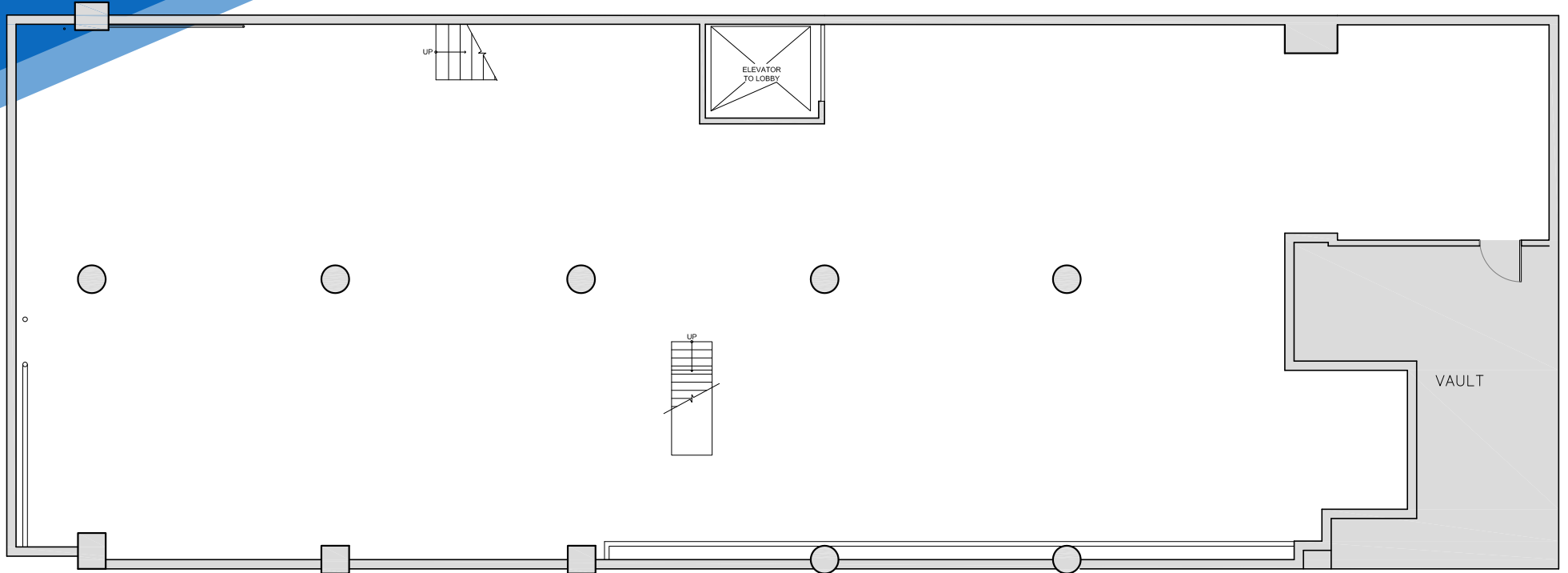

JAMES FAMULARO

President  
646.658.7373  
jfamularo@meridiancapital.com

JORDAN LANGER

Associate  
212.468.5977  
jlanger@meridiancapital.com

JESSICA BLOCKER

Associate  
212.468.5928  
jblocker@meridiancapital.com



**MERIDIAN**  
RETAIL LEASING

All information supplied is from sources deemed reliable and is furnished subject to errors, omissions, modifications, removal of the listing from sale or lease, and to any listing conditions, including the rates and manner of payment of commissions for particular offerings imposed by Meridian Capital Group. This information may include estimates and projections prepared by Meridian Capital Group with respect to future events, and these future events may or may not actually occur. Such estimates and projections reflect various assumptions concerning anticipated results. While Meridian Capital Group believes these assumptions are reasonable, there can be no assurance that any of these estimates and projections will be correct. Therefore, actual results may vary materially from these estimates and projections. Any square footage dimensions set forth are approximate.

28 WEST 27<sup>TH</sup> STREET

NOMAD, NYC | Between Broadway and Sixth Avenue

RETAIL/RESTAURANT FOR LEASE

NEIGHBORS

SEVENTH AVENUE

SIXTH AVENUE

FIFTH AVENUE

MADISON SQUARE PARK

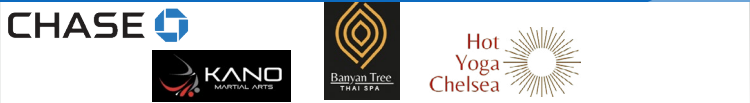

W 27TH STREET



W 26TH STREET



W 25TH STREET



W 24TH STREET

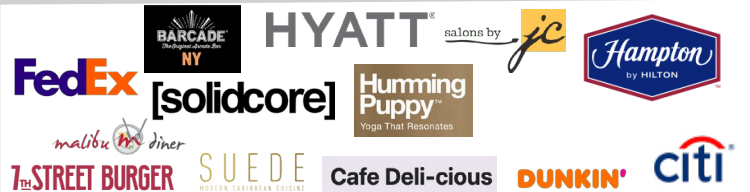

W 23RD STREET



JAMES FAMULARO

President  
646.658.7373  
jfamularo@meridiancapital.com

JORDAN LANGER

Associate  
212.468.5977  
jlanger@meridiancapital.com

JESSICA BLOCKER

Associate  
212.468.5928  
jblocker@meridiancapital.com



MERIDIAN  
RETAIL LEASING

All information supplied is from sources deemed reliable and is furnished subject to errors, omissions, modifications, removal of the listing from sale or lease, and to any listing conditions, including the rates and manner of payment of commissions for particular offerings imposed by Meridian Capital Group. This information may include estimates and projections prepared by Meridian Capital Group with respect to future events, and these future events may or may not actually occur. Such estimates and projections reflect various assumptions concerning anticipated results. While Meridian Capital Group believes these assumptions are reasonable, there can be no assurance that any of these estimates and projections will be correct. Therefore, actual results may vary materially from these estimates and projections. Any square footage dimensions set forth are approximate.